

INSTRUCTIONS

Ski Rack

SK1600/SK1610

ENCLOSED: (1) Ski Rack (Fully Assembled)
 (1) 25" Strap with Superlock Buckle

IMPORTANT: TO AVOID DAMAGE TO THE SKIS, PLEASE FOLLOW INSTRUCTIONS CAREFULLY.

1. Before you begin, please make sure that you have the correct model for your vehicle's ladder. (FIG. 1)
2. Using the simple 3-step procedure shown below, hook Ski Rack onto the 4th step up from the bottom of your ladder. (FIG. 2)
 IMPORTANT: Skis should not extend below vehicle bumper.

DOCKING PIECE

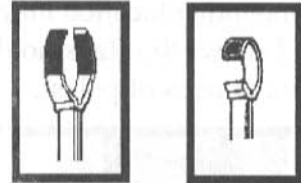

SK1600 SK1610
 Elliptical/Flat Step Round/Square Step

FIG. 1



SK1600
 Elliptical/Flat Step

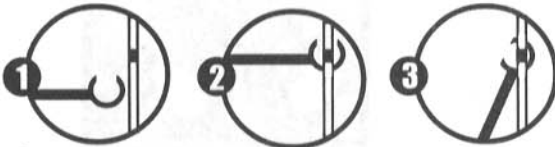

SK1610
 Round/Square Step

FIG. 2

3. With the rack hooked onto the proper step of your ladder, center it between the vertical rails of the ladder. (See FIG. 3)

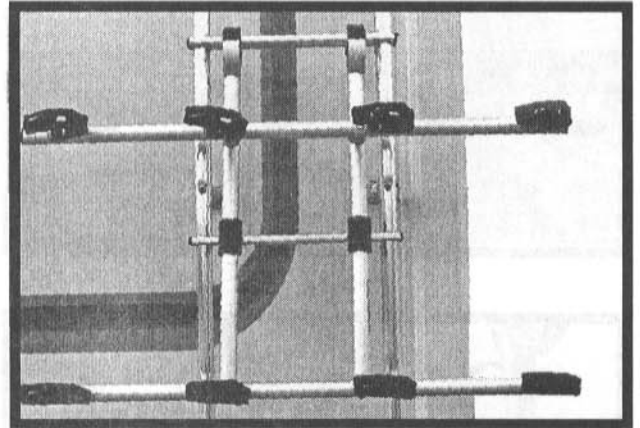

FIG. 3

4. Place 25" strap around center of upper crossbar of the ski rack (See FIG. 5a for location of crossbars), and the step immediately below the crossbar. (FIG. 4a) **PULL STRAP TIGHT!** (You may tie-off any excess length of strap).

Buckles must be threaded as shown in FIG. 4b. The Superlock Buckle must be placed in between the upper crossbar and step--this will tighten the strap. Do not place buckle around or over crossbars or steps.

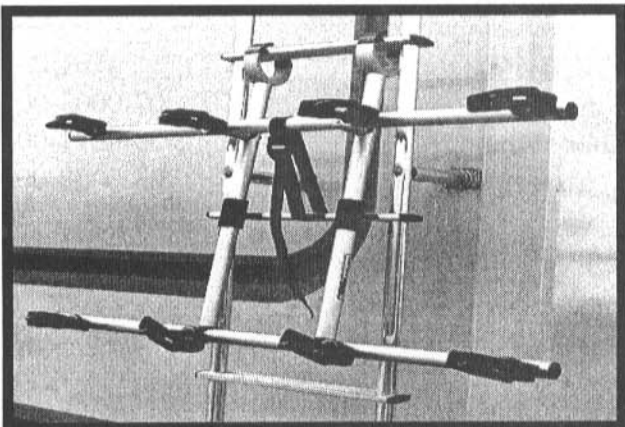

FIG. 4a

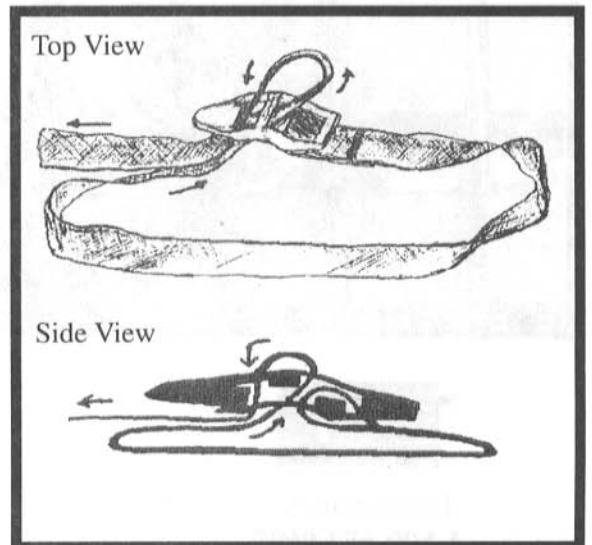

FIG. 4b

5. Load the first pair of skis onto the Ski Rack, placing the skis on the right hand side of the J-Pin. Pull rubber strap AROUND and UNDER the bindings (J-Pins located on upper crossbar should rest under the toe bindings). Hook rubber strap to J-Pin securely, using hole position in rubber strap to provide proper tension for skis. (FIG. 5a and FIG. b)

NOTE: If you are carrying 1 or 2 pairs of skis, use center (2) mounting locations. (FIG. 6) Ski Rack can hold up to 4 pairs of skis. Each mounting location may hold 2-3 sets of poles. (FIG. 7 shows Ski Rack holding 3 pairs of skis and 2 pairs of poles).

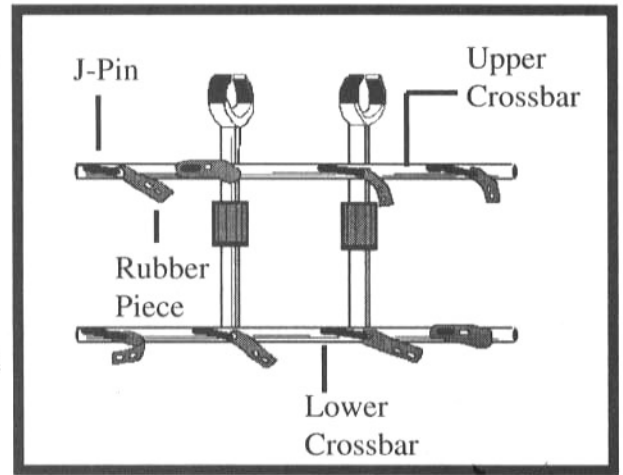

FIG. 5a

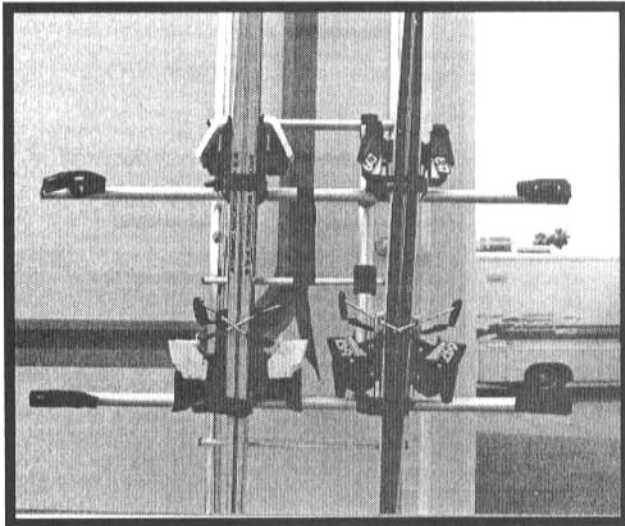

FIG. 6

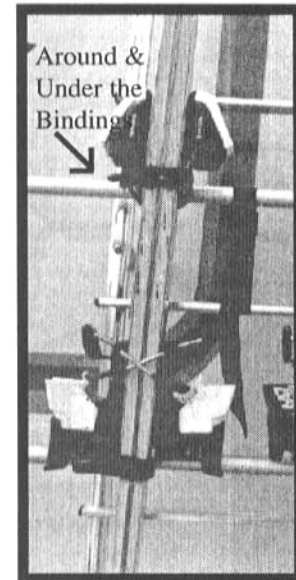

FIG. 5b

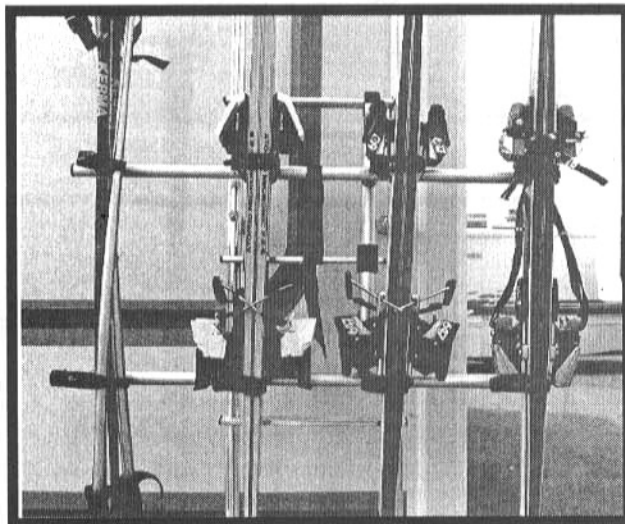

FIG. 7

6. Locking Cable may be used for security. Locking Cable LC2650
7. If you have any questions, comments, or need to order spare parts, please contact Top Line at 1-800-653-0605.
8. Following Spare Parts are available:

DESCRIPTION	PART NUMBER
J-Pin	07-0063-00
Rubber Strap	03-0071-00
25" Strap w/Superlock Buckle	03-0058-00



Paramount, CA
1-800-653-0605